

GPS tracking smart watch ICAR IK101A



Short installation and operating instructions

Full version: <https://nyomkovetes.net>



Based on its design and portability, the device was designed by the manufacturer primarily for tracking and supervising people - as a result, its users can be people of any age. Settings that affect the operation of the device can only be changed from another device (smartphone, computer) using the appropriate application.

ATTENTION!



The watch is suitable for measuring blood pressure and heart rate and transmitting data, but it is not a medical device, its use is not a substitute for a medical examination or appropriate medication.

Distributor

FlexCom Communication Ltd.

2151 Fót, Szent Imre u. 94. HUNGARY

Phone: +36 1 769 1005

Email: info@nyomkovetes.net

Website: <https://nyomkovetes.net>

1. Parts of the device



2. Startup

2.1 Prepare the SIM card and turn on the clock

If you did not obtain your SIM card from your dealer, you must set it up before inserting / using it in your device:

1. Insert the SIM card into your phone. In the phone settings, turn off the PIN code request option,
2. Turn off the auto answer option and call forwarding. After turning off the above, unscrew the SIM cover on the side and insert the card into the device.



After inserting the SIM card, be careful to use **ONLY a MICRO SIM** card (or a suitable adapter) and insert it into the slot in the correct direction / position.

The clock can be switched on using the SOS button. Hold down the button until the clock beeps. Shutdown in the same way or from an application.

2.2 Data traffic setup

If you did not obtain your SIM card from your dealer, you need to connect it to the GSM network. This can be done with the following SMS messages sent to the card's phone number (123456 is the factory default password for the tracking device).

1. Turn on GPRS data traffic
SMS: gprs123456
2. Enter the APN name
SMS: apn123456 (space) APN name
3. Enter the APN username
SMS: apnuser123456 (space) APN username
4. Enter the APN password
SMS: apnpasswd123456 (space) APN password

If your mobile service provider has not provided an APN username and password, messages 3 and 4 do not need to be sent.

In the following examples, the last number consists of two parts, the service provider's MCC / MNC codes.

- MCC: MobileCountry Code (3 digits),
- MNC: Mobile Network Code (2 digits).

Examples:

TELEKOM

pw,123456,apn,internet.telekom,,,21630#

VODAFONE

pw,123456,apn,internet.vodafone.net,,,21670#

pw,123456,apn,vitamax.internet.vodafone.net,,,21670#

TELENOR

pw,123456,apn,online,,,21601#

pw,123456,apn,net,,,21601#

DIGI MOBILE

pw,123456,apn,internet,,,21603#

2.3 Charging the battery

For charging (5V 1A) our phone's charger is suitable, but a computer's USB interface can also be used.

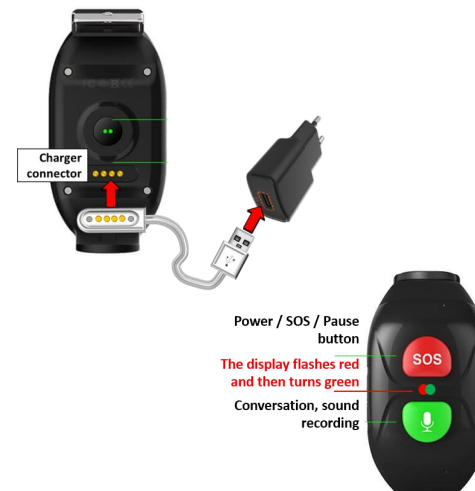

Charging is indicated by a flashing red LED between the two buttons. A green light indicates that charging is complete.

2.4 Install the application

If you have subscribed to a software service from your device vendor, for an Android phone:

1. Open the Google Play app on your phone.
2. Search for "FlexCom" or "FlexCom tracking".
3. Install the tracking application.

The software can be run in a browser on your iPhone or computer at the following website:

<https://gpspositions.net/map>

After launching the application in a browser or phone, carefully read the information on using the software, which can be found in the Help.



ATTENTION!

You need an active internet connection on your phone or computer to use the software!

3. Using the device

LEDs inform the user about the operation and status of the device.

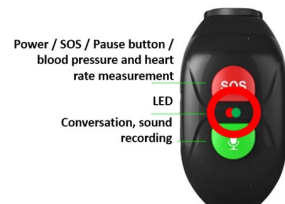

Red:

- Flashes 1 every 5 seconds: low battery (<20%)
- Flashes 1 per 1 second: charging.

Green:

- Flashing for 5 seconds: incoming call indication. steady light: reached the charge level when charging.
- The red and green lights flash alternately during heart rate or blood pressure measurement. When the measurement is complete, if it was successful, green, if it failed, the red light will illuminate for 3 seconds.

Device setup and special commands

The software setup and command sending features are available on the desktop in the following ways:

For desktop application:

- Select the desired device on the map or in the menu.
- Click the Settings or Commands button to select the general setting or send a special command that affects the operation.

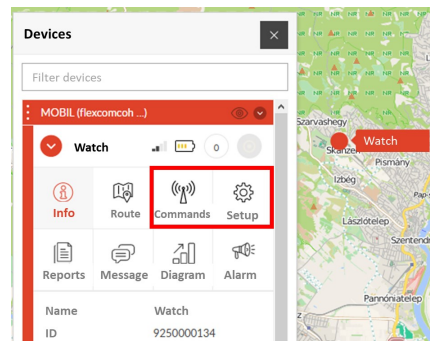

For mobile application:

- From the application menu, select Map.
- Switch to the Tools panel.

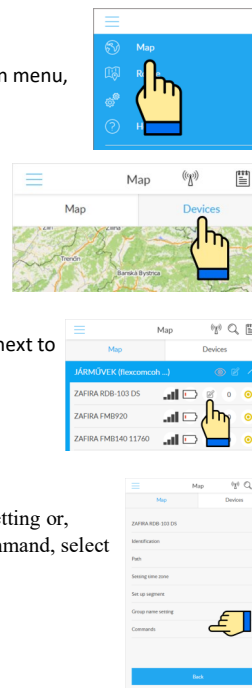

- Tap the Setup icon next to the ID.
- Select the desired setting or, when sending a command, select Commands.

Function	Explanation, parameters to be specified
Set up a central telephone number	Enter the phone number to which the device will send your messages and calls.
Set device PIN	Enter the device security PIN. ATTENTION! If you change the PIN code, you must use the changed PIN code in SMS messages sent from your own phone that are not initiated from the software.
Block an unknown number	Enable or disable barring of calls from numbers other than central and SOS telephone numbers.
Set language	Enter the language for the device displays. Currently, this is English only.

Remote shutdown	When the command is sent, the device switches off.
Low battery alarm	If you turn on the function, the device will send an SMS message to the central telephone number when the battery voltage level is low (when 20% is reached).
Pedometer (sports function)	When switched on, the device performs a step count (until the function is switched off), the result of which can be queried in the software.
Step counting period	Schedule the step count function. The count is activated every day for the specified period.
Do not disturb period setting	Three periods (with hour / minute limits) can be set during which the clock does not receive communication.
Set sleep time	During the specified period, the watch measures the rotation of its owner (during sleep).

SOS call	If you press and hold the SOS button for at least 3 seconds, you will dial the set SOS phone numbers in a row — until the connection is successful, but not more than twice each time.
SOS alarm (SMS)	If SOS alarm is activated, the device sends an SMS message to the SOS phone numbers if you activate the function.
Time zone	From the list, you can select the time zone in which the device operates. In the case of Hungary, it is GMT + 1: 00.
Alarm clock	The device sounds an alarm at the specified time. When Repeat is turned on, it repeats all or on the specified days.
Restart	To send the command, the device turns off and then restarts. It is advisable to use it if you notice any disturbances in its operation.
Blood pressure	The device performs a blood pressure measurement and sends the measured value to the central system.

Scheduled position upload	<p>The device uploads its geographical coordinates to the central system at intervals selected from the list. Map tracking works based on these coordinates and the more accurate this upload, the more accurate it is. The optimal setting can be experimented individually based on needs and practice.</p> <p>ATTENTION!</p> <p>When setting the data upload frequency, make sure that the watch only updates the GPS coordinates in all situations if the frequency is set to 10 or 30 seconds - otherwise (eg at 60 seconds) only if you are moving or we enforce this with a separate message.</p>
Search the clock	When turned on, the device beeps to indicate your location.

4. Certifications

This device complies with EU directives on electromagnetic compatibility and equipment designed to be used within the specified voltage range.

RoHS 2011/65/EU (regulation of the use of hazardous substances)
EN60950-1:2006+A11:2009+A1:2010+A12:2011 + A2:2013
Draft ETSI EN 301 489-1 V2.2.1 (2019-03) ETSI EN 301 489-19 V2.1.1 (2019-04)
Draft ETSI EN 301 489-52 V1.1.0 (2016-11) EN 55032:2015 EN 55035:2017
ETSI EN 301 511 V12.5.1 (2017-03)
ETSI EN 303 413V1.1.1 (2017-06)
EN 62311:2008